

LIVE SMART  
LIVE GREEN



WALLFORT  
**Greens**

 DEVELOPED PLOTS  VILLAGE MAHUDA, OLD PATAN ROAD



PCGRERA220618000293  
<https://rera.cgstate.gov.in/>



**wallfort**  
Building Homes

## **MOST ADMIRABLE BRAND OF CENTRAL INDIA**



**145 LAKH SQFT**  
TOTAL LAND DEVELOPED



**50 LAKH SQFT**  
DEVELOPMENT IN PROGRESS



**5000**  
HAPPY CUSTOMERS



**14 YEARS**  
OF RICH EXPERIENCE

Wallfort is name synonymous with Quality, Delivery and Transparency. With landmark projects like Wallfort City, Wallfort Enclave - I, Wallfort Orchid etc. we have come to understand the actual need of the house owner and its dwellers. But the most important thing we take pride in is the trust our patrons have bestowed upon us and the fact that we have always upheld it over the years. Currently executing 17+ projects at various locations in the city of Raipur, Wallfort is a single place for all budgets and requirements.

Wallfort Group is central India's largest business group with business in 5 key sectors like, Real Estate, Jewellery, Ferro Alloys, Financial services and Wealth Management.



Wallfort Properties, most admired real estate company of Central India bring to you a green project with more than 800 plots in secured campus at "Kopidih" situated at Patan Road, with unique features like excellent roads with plantation, proper drainage, water pipe lines, grand entrance gate, a garden with children play area, badminton & lawn tennis court.



# AMENITIES PLAN

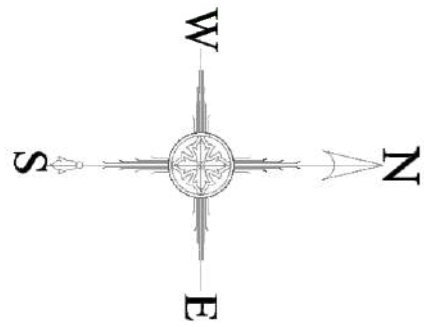

VILLAGE MAHUDA, OLD PATAN ROAD

- 1 - BADMINTON COURT
- 2 - CRICKET GROUND
- 3 - FRUIT GARDEN
- 4 - TENNIS COURT  
SENIOR CITIZEN SIT - OUT  
OPEN GARDEN
- 5 - SKATING TRACK
- 6 - KIDS PLAY AREA  
SAND PIT FOR CHILDREN  
DOG PARK
- 7 - LAWN  
TREE PLANTATION
- 8 - FOOTBALL GROUND  
FEATURE GARDEN
- 9 - BASKET BALL COURT  
FEATURE GARDEN
- 10 - VOLLEYBALL COURT
- 11 - FEATURE GARDEN
- 12 - OLD FOLK CORNER  
YOGA/MEDITATION AREA

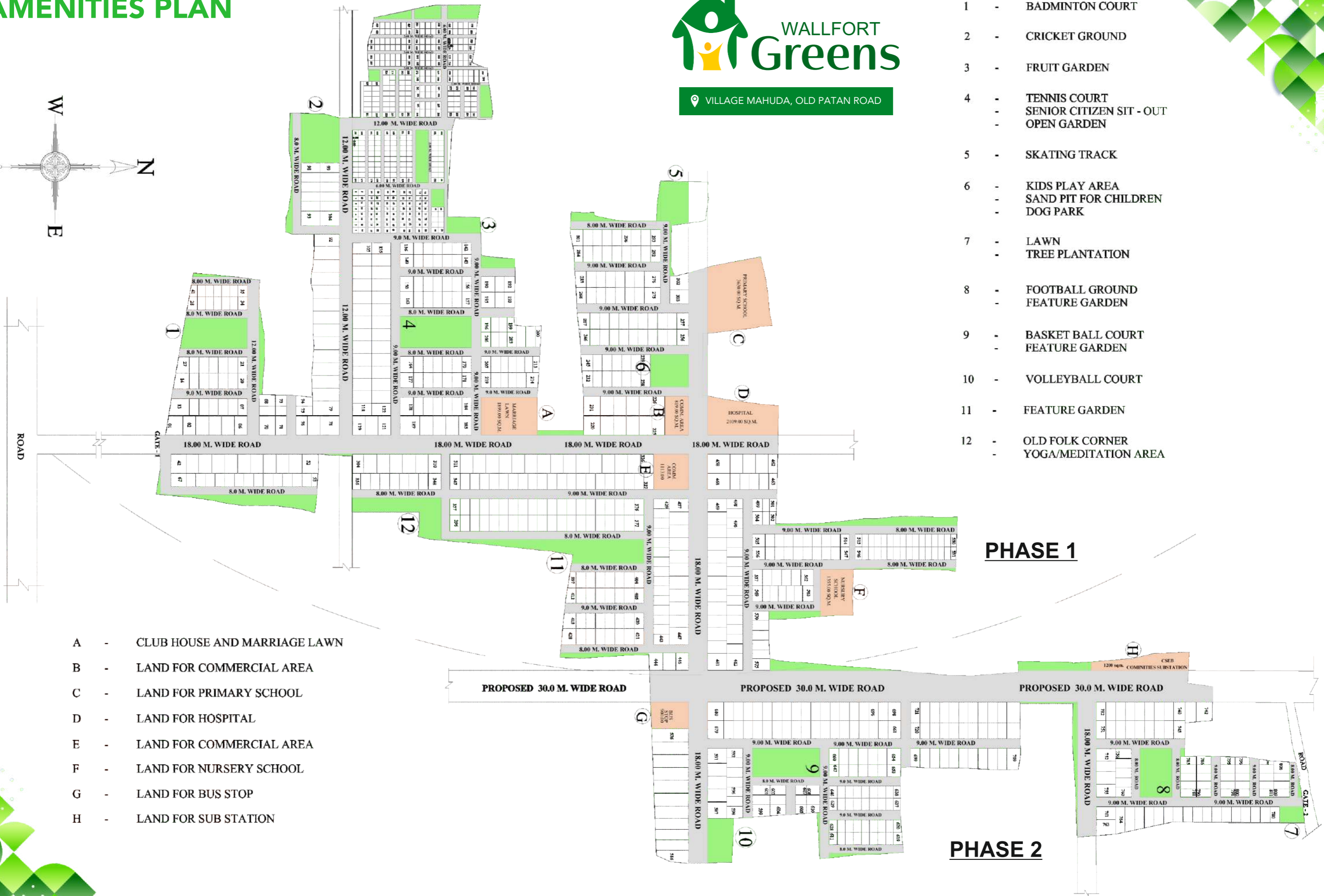

- A - CLUB HOUSE AND MARRIAGE LAWN
- B - LAND FOR COMMERCIAL AREA
- C - LAND FOR PRIMARY SCHOOL
- D - LAND FOR HOSPITAL
- E - LAND FOR COMMERCIAL AREA
- F - LAND FOR NURSERY SCHOOL
- G - LAND FOR BUS STOP
- H - LAND FOR SUB STATION

**PHASE 1**

**PHASE 2**

# The security of a gated community with the convenience of technology

-  Grand Entrance Gate
-  Theme Gardens
-  Secured Campus with Boundary Wall
-  Street Light
-  Demarcation 1 Ft Boundary Wall
-  40/60/100 Feet Major Roads
-  Sewage Treatment Plant
-  Water Pipe Line with U/G Tank
-  Rain Water Harvesting

# MAJOR ROAD DEVELOPMENTS MAP

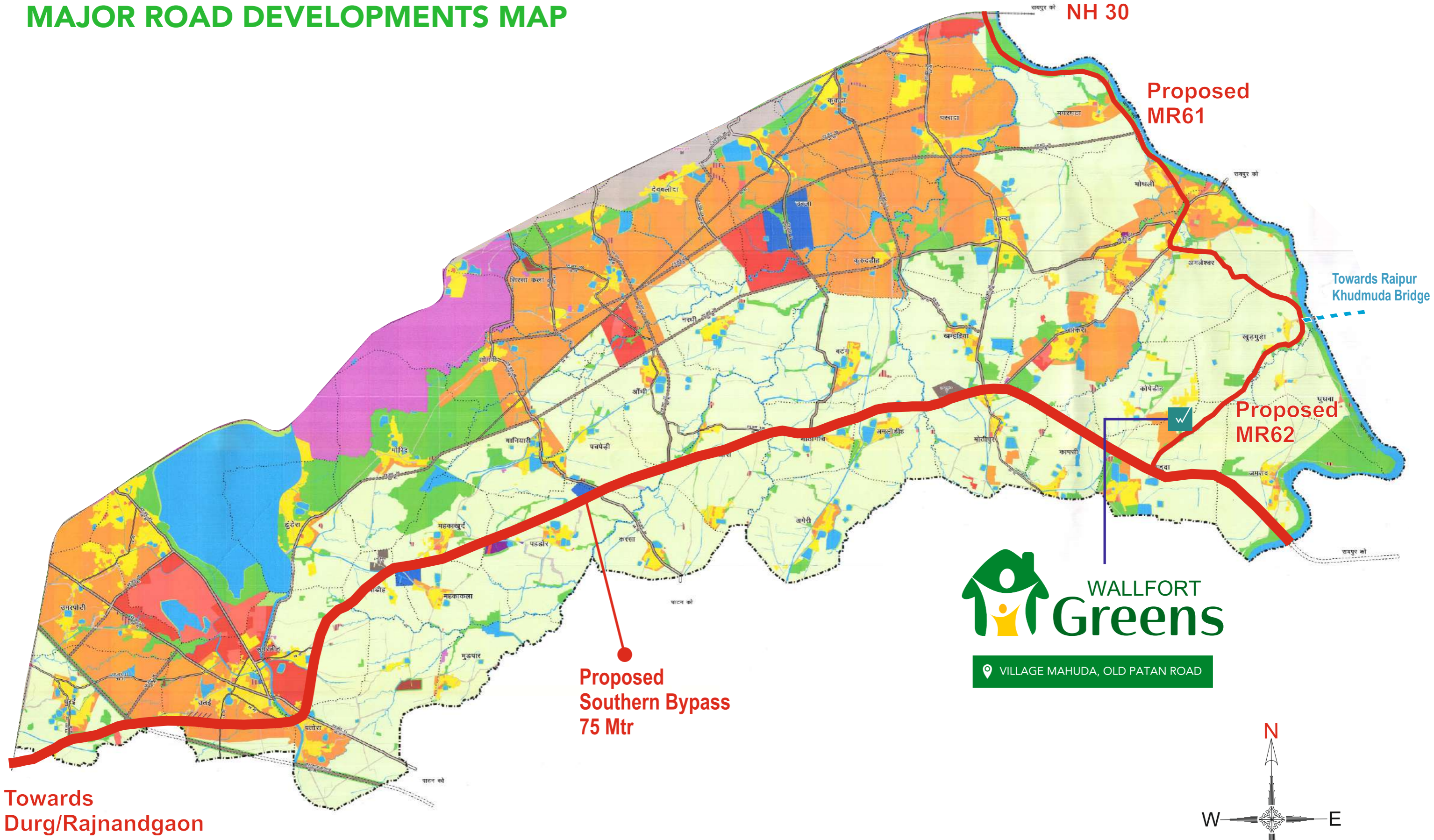

# LOCATION MAP

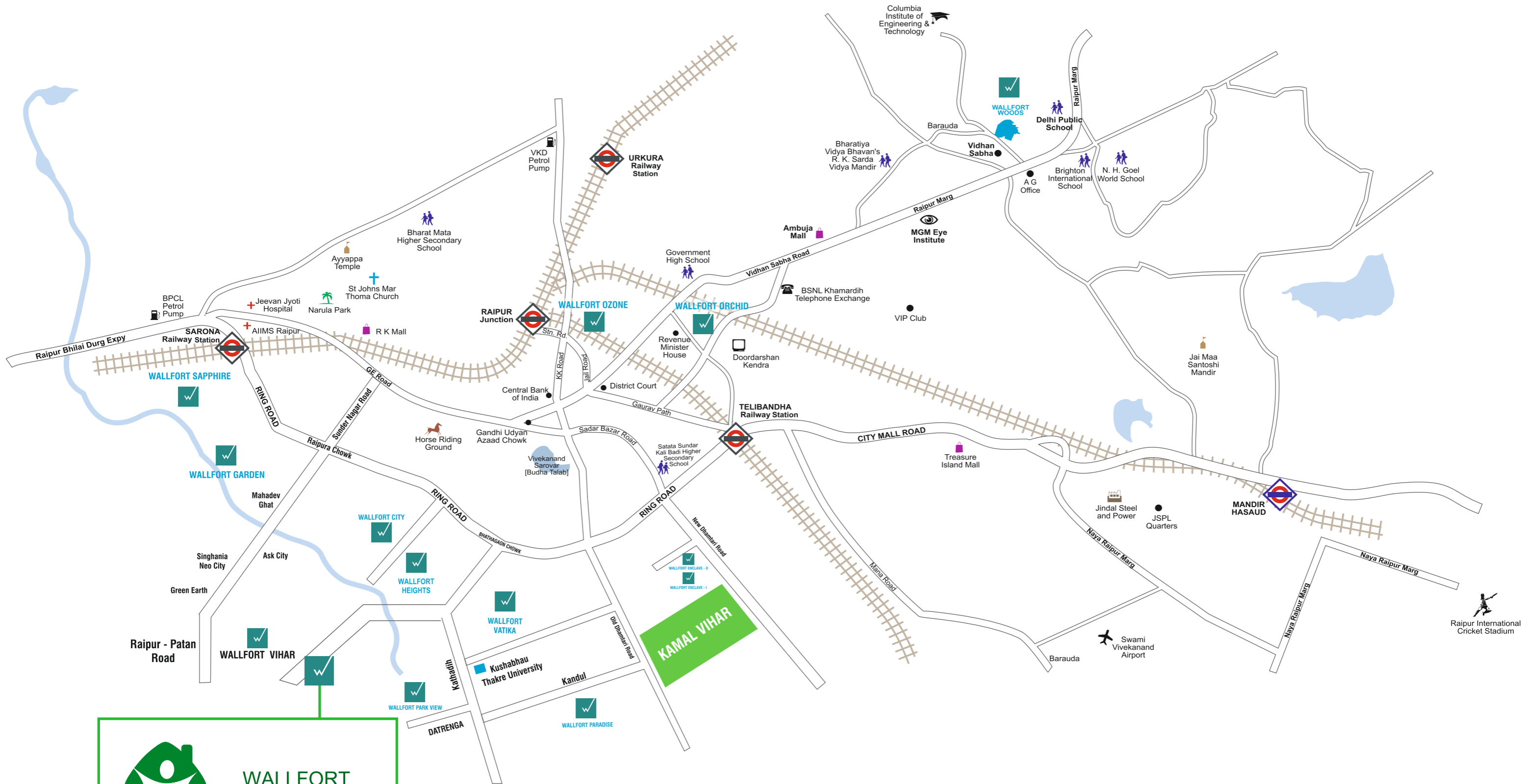

**WALLFORT  
Greens**

VILLAGE MAHUDA, OLD PATAN ROAD

# Everything you need is now just a short drive away!

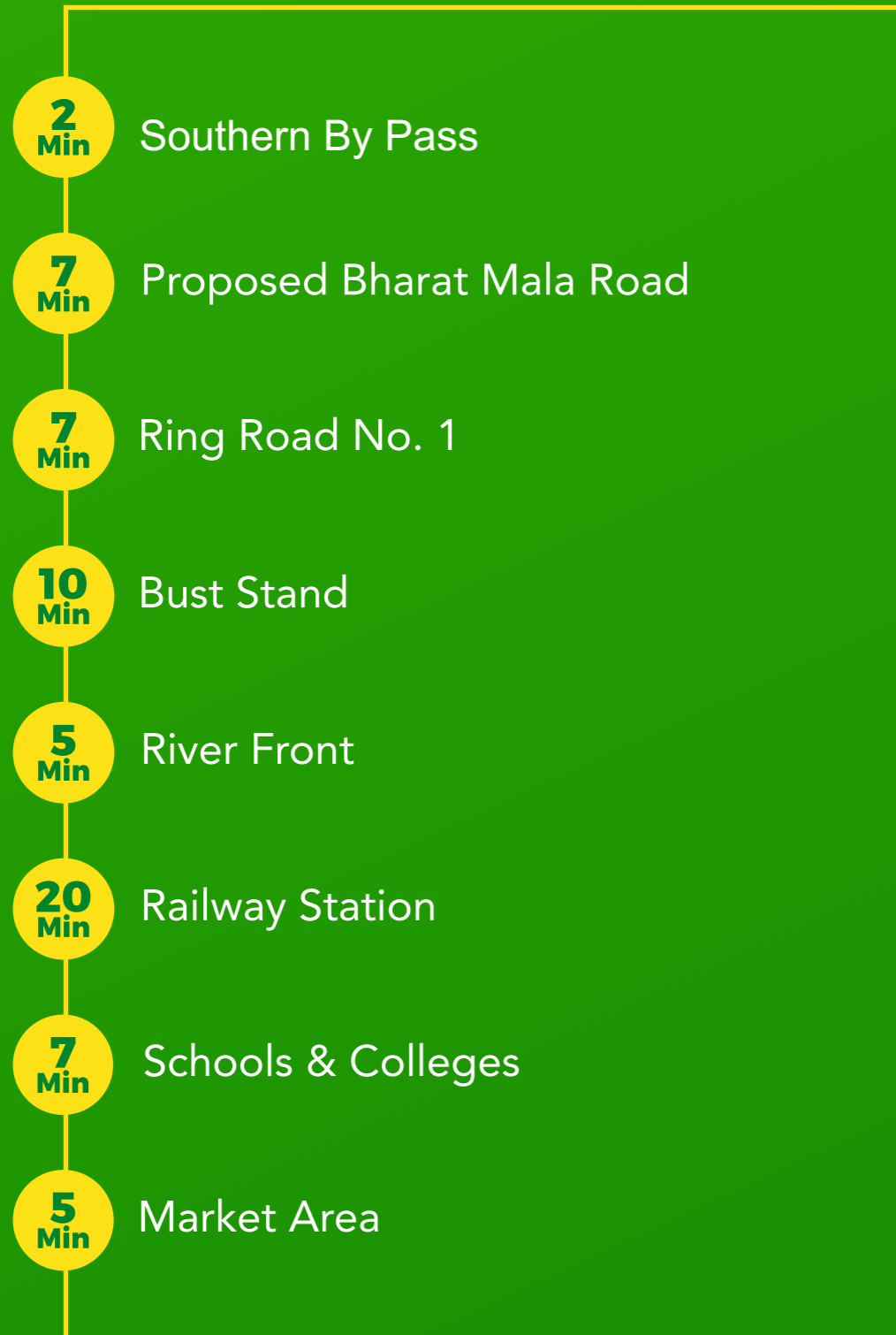

## Lifestyle Amenities

**Gift a beautiful lifestyle to your family!**

Wake up and go for a jog or enjoy a game of badminton with your friends. Spend your weekends relaxing in the pool. Watch your children noisily play outdoors. Celebrate with your friends in the landscaped garden. Invite your friends to experience the joy of clubhouses.



CLUB HOUSE



Landscape Gardens



CRICKET GROUND



GYM



CHILDREN'S PLAY GROUND



TENNIS COURT

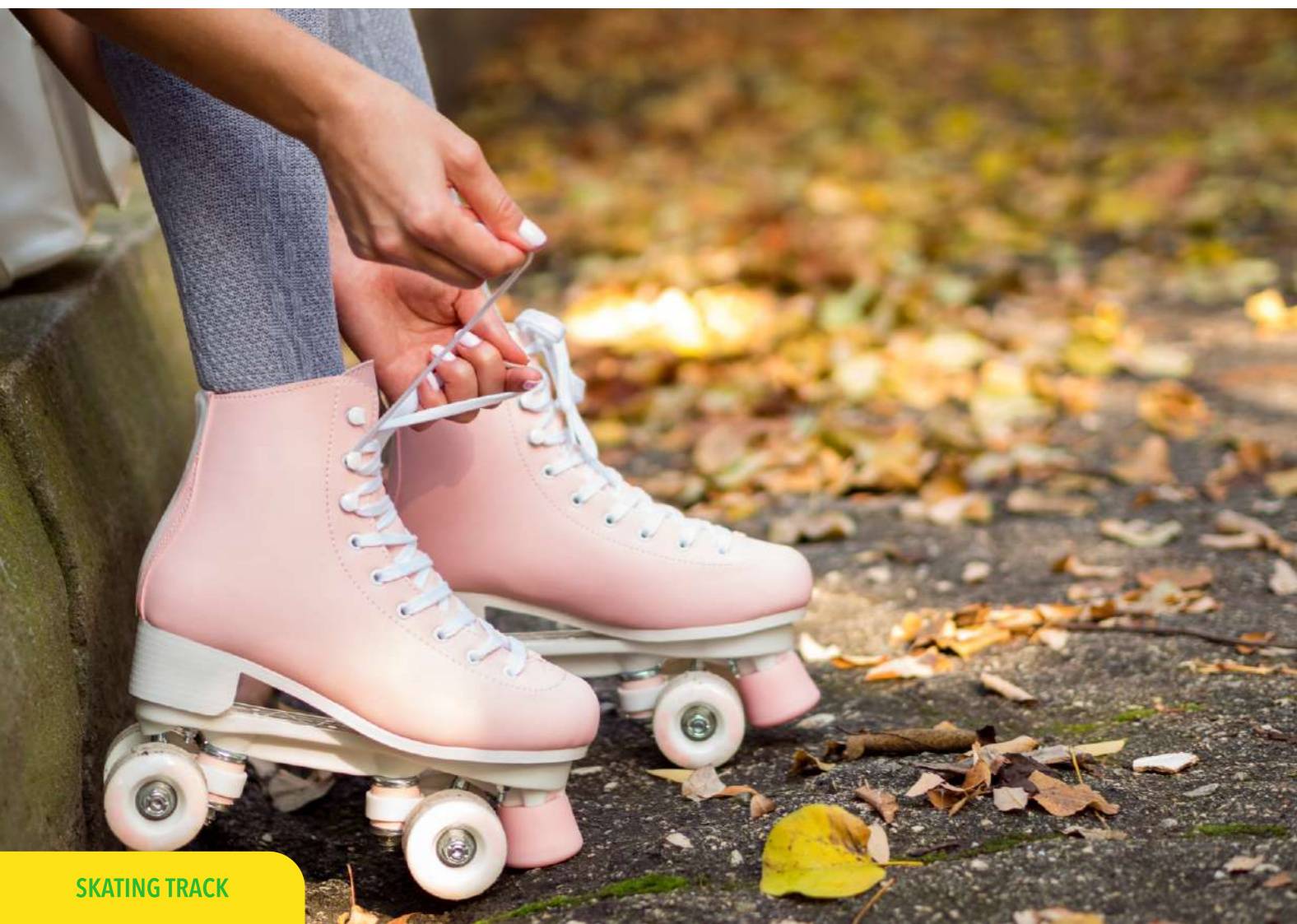

SKATING TRACK



BADMINTON COURT

# Other Projects

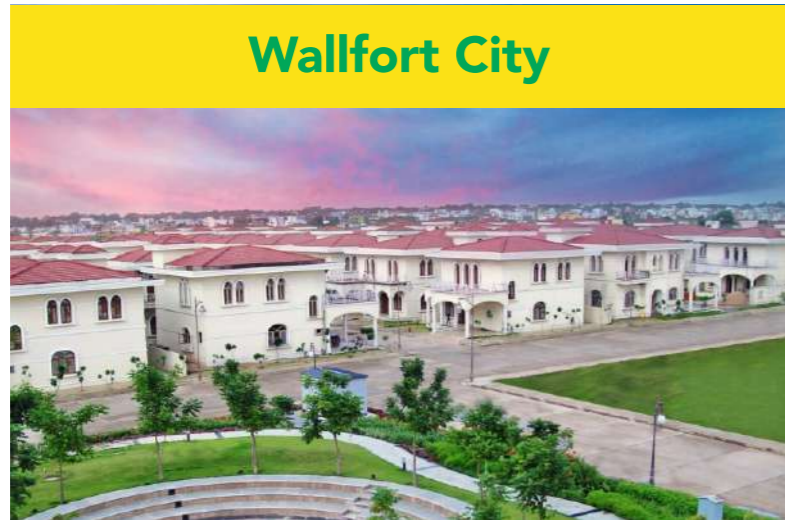

Bungalows  
Ring Road, Bhatagaon



2 & 3 BHK Apartments  
Pachpedhi Naka



Opposite Astha Apartment,  
Near Pani Tanki, Shankar Nagar



1, 2, 3 BHK Flats & 3.5 BHK Bungalows & Plots  
Vidhan Sabha Road, Raipur



3 & 4 BHK Bungalows & Developed Plots  
Kachna Raipur



2 & 3 BHK Flats & Plots  
Mahadev Ghat, Amleshwar



**wallfort**  
Building Homes

**Site Office:** Kopidhi Vilege, Near Kurmuda Village, Tahsil Patan, Dist. Drug

**Head Office:** Wallfort Corporate House, Wallfort City, Bhatagaon Chowk, Ring Road No. 1, Raipur (Chhattisgarh)

[www.wallfortproperties.com](http://www.wallfortproperties.com)